



KLPI cylinder, with built-in pump

Description

Designed for clamping in pullers or in work shop presses, these cylinders have multiple applications in all sectors.

Specifications

- Thrust 10 to 50 tonnes
- Strokes 100, 160 and 220 mm
- Return using built-in spring
- Power supply via built-in automatic dual-flow hand pump, or, remotely, via motor-driven or manual pump
- Guide and stop ring
- Flat or tilting, threaded and detachable piston head
- Pressure gauge connector
- Orientable levers (360°)

KLPI with built-in pump

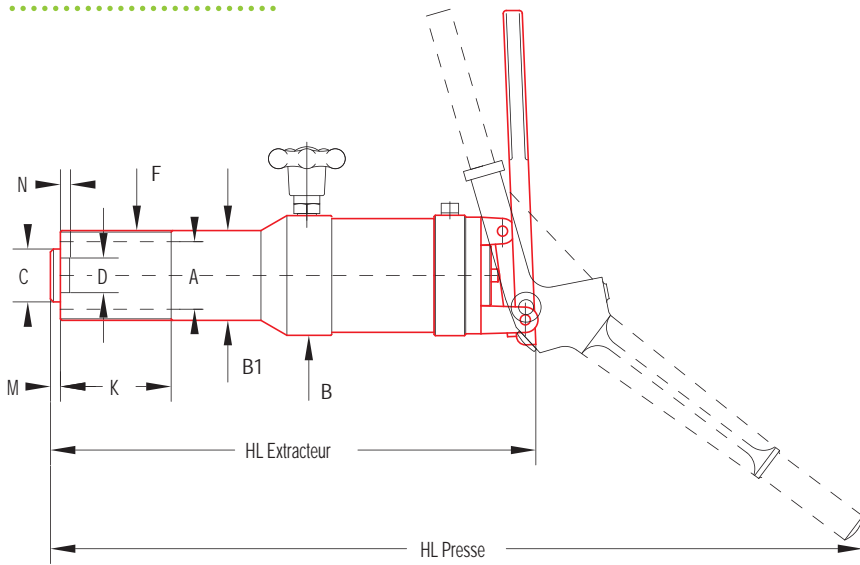

KLPS with separate pump

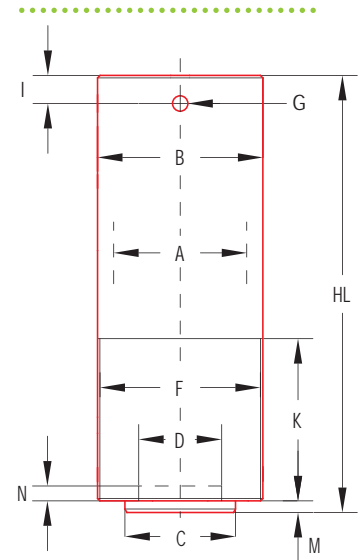

KLPI

Cat Tonnes	Forces kN	Cross-section cm ²	Pressure Bar	Stroke mm	Oil volume dm ³	P/N	Mass kg	Dimensions in mm											Piston adv in mm per lever activation	
								HL Puller	HL Press	A	B	B1	C	D	F	K	M	N	no-load	laden
								10	98	19,63	500	100	0,2	KLPI. 10	11,5	406	527	50	95	70
25	245	28,27	867	160	0,46	KLPI. 25	21	499	780	60	120	90	53	M34X2	M90X3	111	10	10	4,2	0,44
50	490	56,74	865	220	1,3	KLPI. 50	35	672	953	85	120	120	75	M44X2	M120X3	177	10	10	2,2	0,24

KLPS

Cat Tonnes	Forces kN	Cross-section cm ²	Pressure Bar	Stroke mm	Oil volume dm ³	P/N	Mass kg	Dimensions in mm										
								HL	A	B	C	D	F	G	I	K	M	N
10	98	19,63	500	100	0,2	KLPS. 10	5	193	50	70	43	M20X2	M70X2	M20X2	3/8 NPT	51	8	8
25	245	28,27	867	160	0,46	KLPS. 25	11	265	60	90	53	M34X2	M90X3	M34X2		111	10	10
50	490	56,74	865	220	1,3	KLPS. 50	24	335	85	120	75	M44X2	M120X3	M44X2		177	10	10