

Thrust in all positions - Capacity of 20 to 100 tonnes

## Description

Equipped with a central hole allowing the passage of a threaded rod, tie rod or cable through the cylinder, these cylinders are used for bar tensioning, tensile tests, shaft pulling, etc.

The SP.A, SPR.A and DP.A ranges are made of light alloy, their weight is optimised and their manoeuvrability greatly improved over the "steel" version.

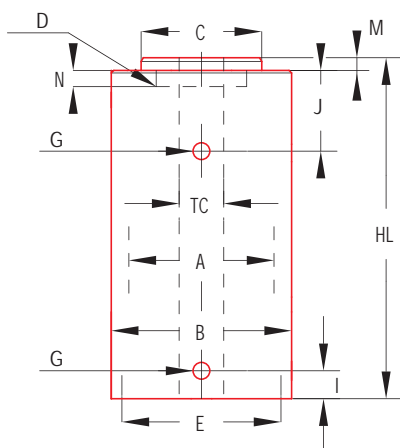

Cat Tonnes	Forces KN	Cross-section cm <sup>2</sup>	Stroke mm	Oil volume dm <sup>3</sup>	P/N	Without spring	With spring	ED	Mass kg	Dimensions in mm										
										HL	A	B	C	D	E	G	I	J	M	Hole TC
20	202	28,86	30	0,087	SP.20.30.L	•			4,9	117	70	92	48	M38 X2	4M10 depth 10 on Ø 65	3/8 NPT	22	5	27	15
			50	0,145	SPR.20.50.L		•	8	190											
			100	0,289	SP.20.100.L	•		7,1	190											
			100	0,289	SPR.20.100.L		•	11,1	274											
			185	0,534	SP.20.185.L	•		9,8	274											
			155	0,447	DP.20.155.L		•	10,1	274											
			255	0,736	DP.20.255.L		•	13,4	371											
30	334	47,72	30	0,143	SP.30.30.L	•			8,8	127	90	118	60	M48 X2	4M10 depth 13 on Ø 95	3/8 NPT	25	7	33	20
			75	0,358	SPR.30.75.L		•	16,8	246											
			145	0,692	SP.30.145.L	•		14,7	246											
			150	0,716	SPR.30.150.L		•	25,7	384											
			275	1,312	SP.30.275.L	•		22,2	384											
			265	1,272	DP.30.265.L		•	23	384											
			335	1,598	DP.30.335.L		•	26	456											
45	467	66,76	30	0,2	SP.45.30.L	•			12,9	130	110	145	75	M63 X2	4M10 depth 13 on Ø 115	3/8 NPT	25	7	50	20
			75	0,5	SPR.45.75.L		•	25	254											
			150	1	SP.45.150.L	•		22,8	254											
			150	1	SPR.45.150.L		•	38,5	398											
			275	1,836	SP.45.275.L	•		33,2	398											
			260	1,736	DP.45.260.L		•	34	398											
			400	2,67	DP.45.400.L		•	43,4	534											
60	649	92,83	75	0,696	SPR.60.75.L		•		30,5	284	135	165	100	M85 X2	4M12 depth 13 on Ø 130	3/8 NPT	29	10	63	20
			165	1,532	SP.60.165.L	•		28	284											
			150	1,392	SPR.60.150.L		•	44	417											
			300	2,785	SP.60.300.L	•		40	417											
			245	2,274	DP.60.245.L		•	42,5	417											
			375	3,481	DP.60.375.L		•	56	545											
100	982	140,41	75	1,053	SPR.100.75.L		•		50	307	170	206	128	M112 X3	4M14 depth 22 on Ø 170	3/8 NPT	37	15	90	20
			170	2,387	SP.100.170.L	•		46	307											
			150	2,106	SPR.100.150.L		•	73	435											
			300	4,212	SP.100.300.L	•		67	435											
			250	3,51	DP.100.250.L		•	70,5	435											
			435	6,108	DP.100.435.L		•	82	618											