



Description

These compact, lightweight and easy-to-handle cylinders can be used in the most restricted areas. Ideal for lifting heavy items with difficult access.

Specifications

- Thrust 5 to 220 tonnes
- Stroke 15 mm
- Piston load return
- Smooth piston
- Anti-seizing, corrosion-proof treatment
- Guide and stop ring
- Screw-on female 1/2 coupler 3050.3 with protective cap

On request

- Piston return using built-in spring
- Tilting piston head
- Clamping holes

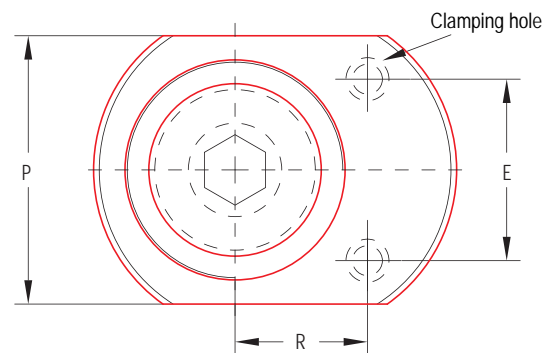
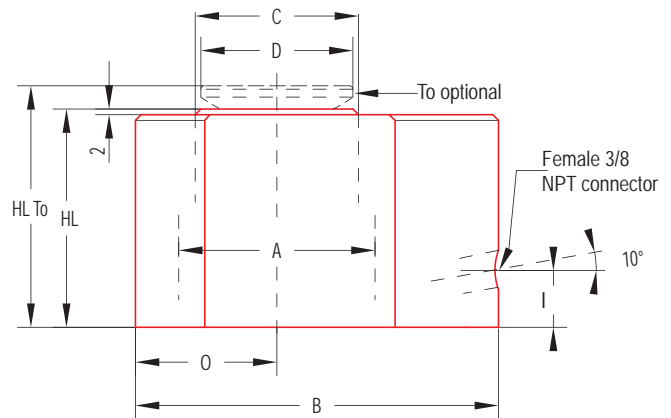

Cat Tonnes	Forces KN	Cross-section cm ²	Stroke mm	Oil volume dm ³	P/N	Mass Kg		Dimensions in mm										
						L	L.TO	HL	HL.TO	A	B	C	D	E	I	O	P	R
5	57	8,04	15	0,012	UB.5.15.L	1,2	1,25	46	53	32	76	28	28	32 2 x Ø 8.5	16	25	50	32
9	88	12,56	15	0,019	UB.9.15.L	1,7	1,75	49	58	40	85	35	35	37 2 x Ø 8.5	16	30	60	35
14	137	19,63	15	0,03	UB.14.15.L	2,6	2,7	56	65	50	95	43	43	42 2 x Ø 8.5	17	35	70	39
22	218	31,17	15	0,047	UB.22.15.L	3,6	3,75	61	71	63	107	53	53	50 2 x Ø 10.5	17	42,5	85	43
35	352	50,26	15	0,076	UB.35.15.L	5,8	6,3	66	81	80	128	73	75	65 2 x Ø 10.5	18	53,5	107	50
55	550	78,54	15	0,118	UB.55.15.L	8,7	9,6	71	90	100	153	90	93	80 2 x Ø 10.5	18	67	134	60
85	859	122,7	15	0,184	UB.85.15.L	16	17,3	84	103	125	185	112	107	100 2 x Ø 10.5	22	85	170	70
105	1077	153,9	15	0,23	UB.105.15.L	18,4	21	91	116	140	185	127	135	None	22	89	188	None
140	1407	201,1	15	0,302	UB.140.15.L	26,3	29	95	120	160	218	146	135	None	22	104	218	None
220	2200	314,1	15	0,472	UB.220.15.L	41	45	111	136	200	248	178	165	None	22	124	248	None